



Greens Sanding Machine

KM-400Y

Operation Manual



Shouguang Nake Garden Machinery Co., Ltd

Thank you for purchasing the KM-400Y putting greens topdressing machine from
Nake Sports Turf Machinery.

Please read this manual completely, otherwise you may be injured or damage the
equipment. This manual should be kept with you forever and sent to you as the user.

This manual uses the metric standard. The person sitting on the main machine faces the
direction of the machine. The left and right of the person are the left and right of the
machine. If you encounter a dotted arrow, it means that the parts are hidden inside.

Nake Machinery provides warranty to customers who operate and maintain according
to the requirements of this manual as part of the entire support program. The warranty
of this product can be explained in the warranty certificate received from the dealer.

Purchase date:

Dealer name:

Phone:

Serial number:

Table of contents

1. Introduction.....	
2. Main specifications and technical parameters.....	
3. Important safety operations.....	
4. Functions of each component.....	
5. Safety inspection before operation.....	
6.Components exploded view.....	

1. Introduction

KM-400Y is a new type of greensand-topped equipment with good control performance. The comfortable seat and convenient control can greatly reduce the labor intensity of the operator and save physical strength. The drive wheel adopts a disconnected differential wrapped rubber roller, which can reduce the damage to the green turf and can also replace the green turf rolling equipment to complete the rolling operation of the green.

KMT400Y adopts a low-noise HONDA GX270 gasoline engine, a large-displacement hydraulic system, and HST can better control walking.

2. Main technical specifications and technical parameters

Model: **KM-400Y**

Working width: 900mm

Engine model: HONDA GX270

3. Important safety operations

PLEASE READ AND UNDERSTAND BEFORE OPERATING MACHINE

You must read the details of the instruction manual and understand the various performances of the machine before you can operate the machine. Improper operation may cause mechanical failure and accidents. It is forbidden for underage children to operate the machine. Adults must be trained before operating the machine. Before using the machine, the work site must be carefully checked, especially the roads in and out of the site. The machine is not equipped with lighting devices and is prohibited from operating at night. Before starting the engine, all drive device operating handles must be placed in the [cut] position and the parking handbrake must be pulled up and locked. When working on a sloped area, it is prohibited to advance or stop suddenly. When turning and turning on a sloped area, please reduce the speed and run at a low speed to prevent dangerous accidents caused by poor braking. When turning on a sloped area, please pay attention to lookout and drive carefully at a low speed. The

flammability of the fuel is very high. The following points must be noted when using it:

- 1) Specify unleaded gasoline for automobiles. 2) It must be added after the engine is stopped and fully cooled. It must be added outdoors. The spilled part should be wiped clean in time. 3) When adding fuel, fireworks are strictly prohibited.
- 4) When the fuel is used for cleaning, please be careful of fireworks.

When parking, please turn off the fuel switch for the remaining fuel in the fuel tank.

When parking for a long time, the remaining oil in the fuel tank should be drained cleanly. When storing indoors, the engine must be fully cooled before parking.

When starting the engine in the storage warehouse, the ventilation device should be turned on to prevent carbon monoxide poisoning.

After the parts are worn or damaged, please replace them with genuine parts before operating.

When the machine is repaired and maintained, the safety protection device can be removed, otherwise the safety protection device shall not be removed.

If the machine encounters foreign objects or has abnormal sounds or abnormal vibrations, please stop the machine immediately, check or repair it, and confirm that the machine is normal before operating.

When adjusting the engine governor, please be careful not to exceed the rated operating speed of the engine.

When the machine is driving backward, the situation behind and the road conditions must be confirmed.

The machine shall not be driven on public roads. In addition, when driving or working, check for people in front, behind, left, right, and around you.

To ensure the good performance of the machine, regular maintenance must be performed once a year.

4. Functions of each component

1. Frame

The installation parts of the loading bucket, engine, and gearbox are affected by the

accumulation of sand, grass clippings, dead leaves, etc., which may cause corrosion damage and cause major accidents, so they must be inspected and maintained regularly.

2. Loading bucket

The loading bucket capacity of this machine is 0.3m³. It can load sand, fertilizer, etc. The machine cannot be overloaded, otherwise it will cause damage to the gears and bearings of the drive unit. It must be parked on a flat ground when loading.

3. Engine

The engine uses HONDA[GX270]. Please refer to the engine manual for details.

4. Front wheel

The front wheel uses dual tires to reduce the rolling of the lawn.

5. Rear roller

The uneven area is rolled flat during operation, and the sand covering effect is better.

6. Rolling brush

The wear of the brush and the looseness of the bearing will affect the flatness of the sand covering, so it must be checked frequently.

7. Width indication

Width indication during sand covering operation.

8. Armrest handle

Used for driving steering operation, throttle handle and brake handle are installed on the armrest handle.

9. Baffle opening and closing adjustment handle

Used to adjust the thickness of sand covering.

10. Brake handle

Used to slow down and stop during driving.

11. Operation clutch operating handle

The handles on the outside of both sides are linked {considering the operator's habits}, pull up to enter, the conveyor belt runs, and the rolling brush runs. Pull down to cut, the conveyor belt and rolling brush stop running.

12. Travel clutch operating handle

The handles on the inside of both sides are linked {considering the operator's habits}, pull up to enter, the machine travels. Pull down to cut, the machine stops.

13. Parking hand brake

The parking hand brake on the side is used when the machine is parked. Pull up to lock the parking lock, and when releasing, press the lock button to pull up and then release it.

5.Safety inspection before operation

1. Engine oil

- Confirm the amount and cleanliness of the engine oil every day, add it in time if it is insufficient, and replace it in time if it is dirty.
- Replace the engine oil after 25 hours of use for a new machine, and replace it every 50 hours thereafter.
- The engine oil must use the specified Shell 15W-40.

2. Hydraulic system oil

- The hydraulic oil is first replaced after 50 hours of use for a new machine, and then every 100 hours thereafter.

3. Fuel

- Use unleaded gasoline for automobiles.
- When adding fuel, the engine must be stopped and done outdoors.
- When adding fuel, fireworks are strictly prohibited.
- After adding fuel, the fuel tank cap must be tightened.
- Spilled fuel must be wiped clean in time.
- Make sure there is enough fuel in the fuel tank before operation.

4. Air filter element

- A clean filter element can ensure that clean air is provided to the engine.
- Please use genuine parts.

5. Front tire

- Cracks, wear and other external injuries must be confirmed.
- The air pressure of the tire must be guaranteed to be within the specified range.

6. Brakes

- The action and effect of the brakes must be checked.
- The wear condition must be checked once every 6 months.

7. V-belt

- When the clutch is in the cutting position, check the tightness of the belt and the crack condition of the belt.

8. Rolling brush

- The distance between the brush and the conveyor belt is 1-2mm. Wear will affect the uniformity of the sand coating.

If necessary, adjust and replace.

9. Check the fastening bolts of each part

- The machine uses fastening bolts in many places, and they are all fastened in a static state. Therefore, after the first use, the tightness of each fastening bolt must be checked and tightened according to the standard torque.

10. Inspection and adjustment of conveyor belt {snake-type adjustment method}

- The conveyor belt of this machine is adjusted under no-load condition before leaving the factory. After initial use, it can be adjusted according to the tightness of the belt. When adjusting, adjust one side first, then adjust the other side, and adjust both sides step by step.

6. Exploded view of parts

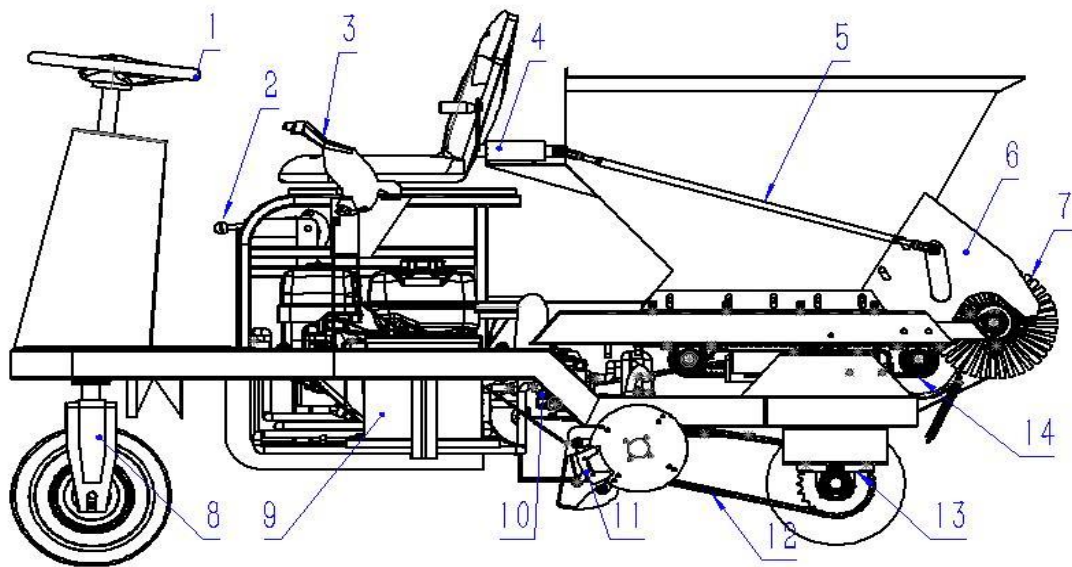

Item	Part No.	Description	Qty.	Serial Numbers/Notes
01	N88-4954	Steering wheel	1	方向盘
02	N70-1626	Handbrake	1	手刹器
03	N87-7753	Handrail	2	扶手
04	N95-3187	Manual regulator	1	手动调节器
05	N75-5854	connecting rod	1	连杆
06	N32-5341	Protective board	1	护板
07	N96-3676	Rolling brush	1	滚刷
08	N96-5458	Bracket	1	支架
09	N15-1560	Battery	1	蓄电池
10	N66-4492	transmission case	1	变速箱
11	N95-6451	Chain wheel	1	链轮
12	N60-3926	chain	1	链条
13	N90-2731	Chain wheel	1	链轮
14	N82-5191	Chain wheel	1	链轮

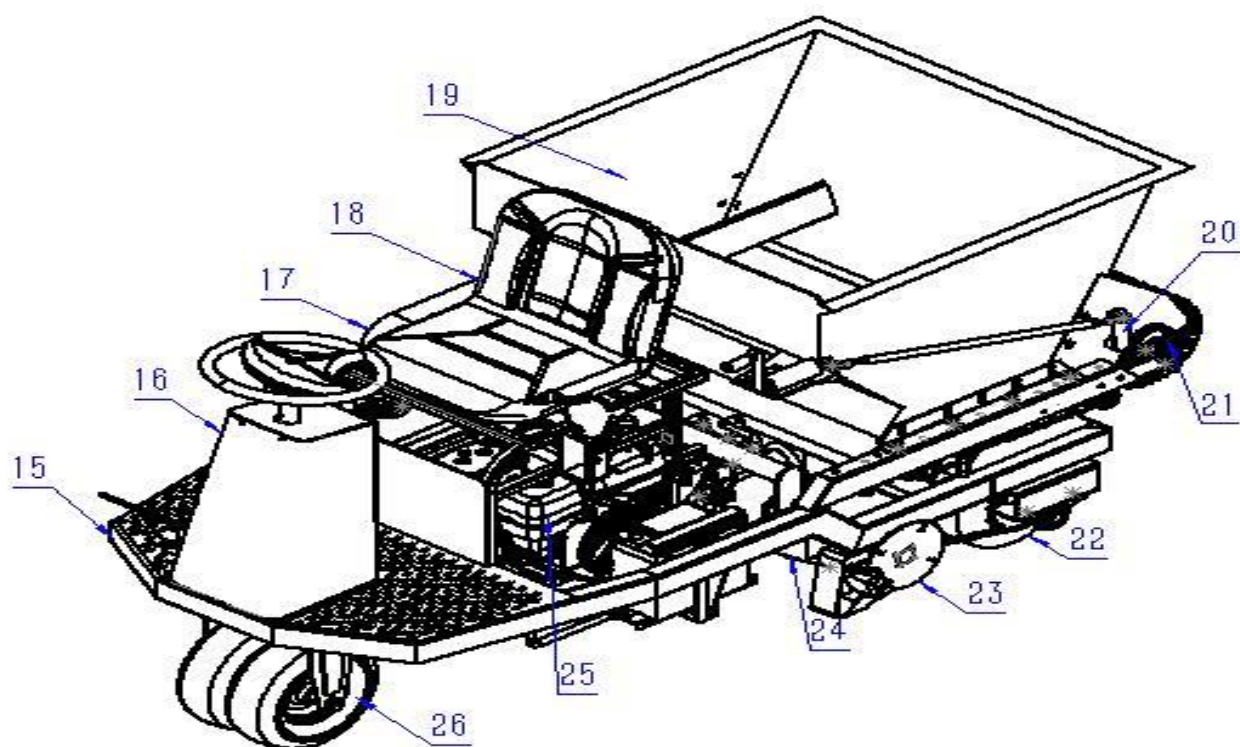

Item	Part No.	Description	Qty.	Serial Numbers/Notes
15	N65-8350	floor	1	底板
16	N60-6103	Protective board	1	护板
17	N99-8361	chair	1	座椅
18	N60-7810	Handrail	2	扶手
19	N86-6516	Hopper	1	料斗
20	N32-5791	Connector	1	连接器
21	N80-5487	Bearing	1	轴承
22	N96-9163	Rubber roller	2	胶辊
23	N32-2371	Chain wheel	1	链轮
24	N93-8770	chain	1	链条
25	N87-4312	engine	1	发动机
26	N57-3426	tyre	2	轮胎

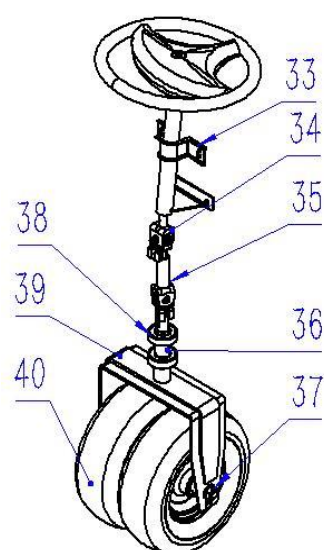
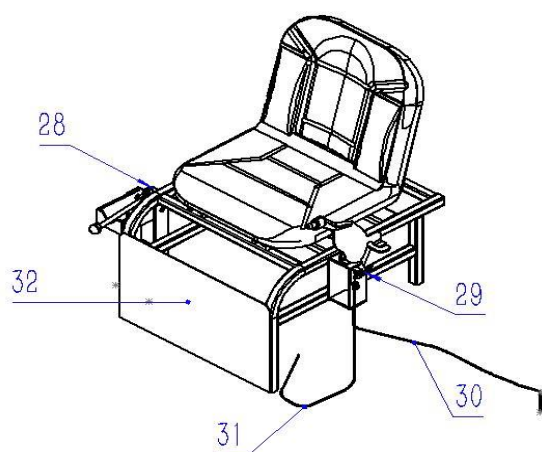
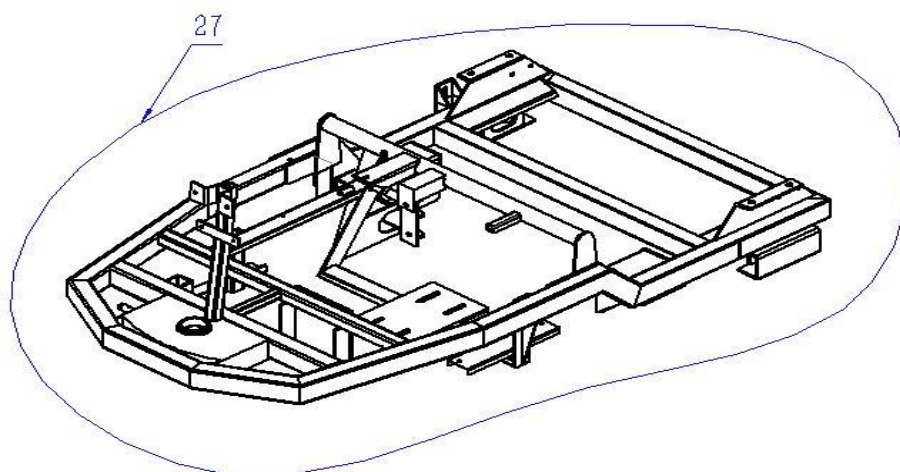

Item	Part No.	Description	Qty.	Serial Numbers/Notes
27	N60-1333	Frame	1	车架
28	N96-8200	Hand brake	1	手刹
29	N60-2578	Regulator	1	调节器
30	N82-5245	Pull the wire	1	拉线
31	N80-5313	Protective board	1	护板
32	N65-3046	Protective board	1	护板
33	N36-5871	Fixing device	1	固定器
34	N10-9551	Cross Festival	1	十字节
35	N88-3466	Pressure bearing	1	压力轴承
36	N52-0509	axis	1	轴
37	N99-8741	Nut	2	螺母
38	N96-6610	Pressure bearing	1	压力轴承
39	N60-3811	Bracket	1	支架
40	N85-2995	tyre	条	轮胎

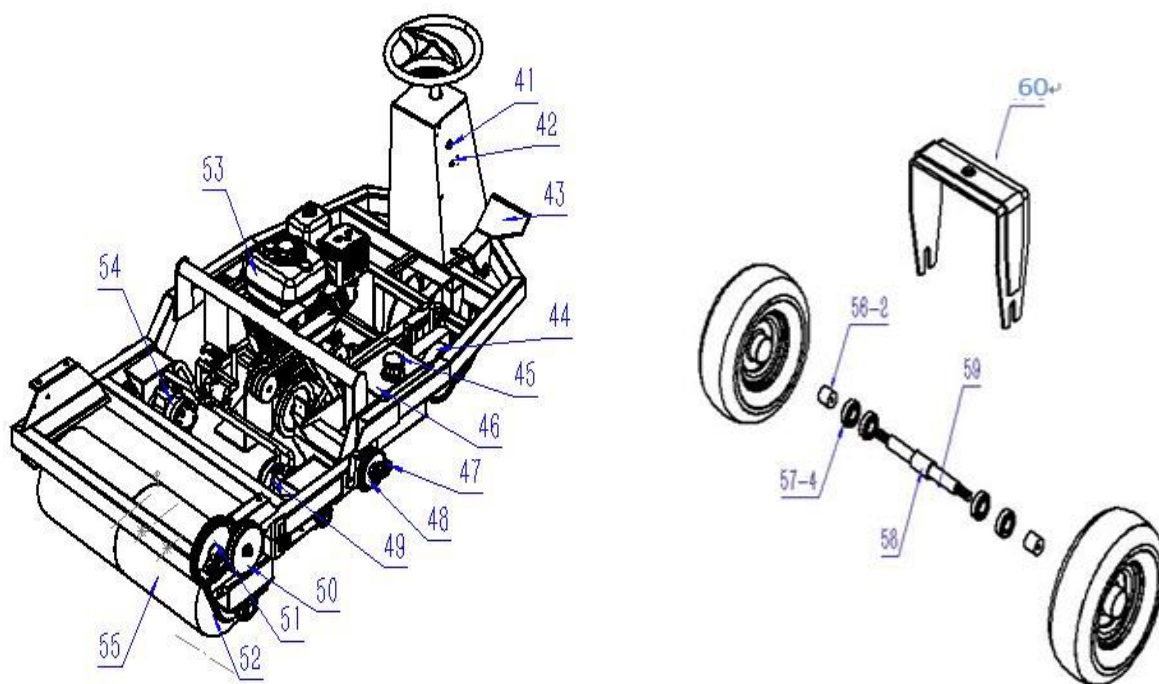

Item	Part No.	Description	Qty.	Serial Numbers/Notes
41	N72-4039	screw	1	螺杆
42	N97-9637	screw	1	螺杆
43	N15-2391	pedal	1	踏板
44	N96-2095	Hydraulic pump	1	液压泵
45	N85-6316	Hydraulic oil tank cap	1	液压油箱盖
46	N93-1144	Hydraulic oil tank	1	液压油箱
47	N72-4222	Nut	1	螺母
48	N96-8656	Chain wheel	1	链轮
49	N76-3637	Hydraulic motor	1	液压马达
50	N78-2768	Chain wheel	1	链轮
51	N85-8851	Chain wheel	1	链轮
52	N62-7225	chain	2	链条
53	N76-8392	engine	1	发动机
54	N25-8081	Hydraulic motor	1	液压马达
55	N80-5721	Rubber roller	2	胶辊
56	N15-8913	Bearing	4	轴承
57	N70-9261	set	4	套
58	N78-2324	set	1	套
59	N10-6247	axis	1	轴
60	N96-7789	Bracket	1	支架

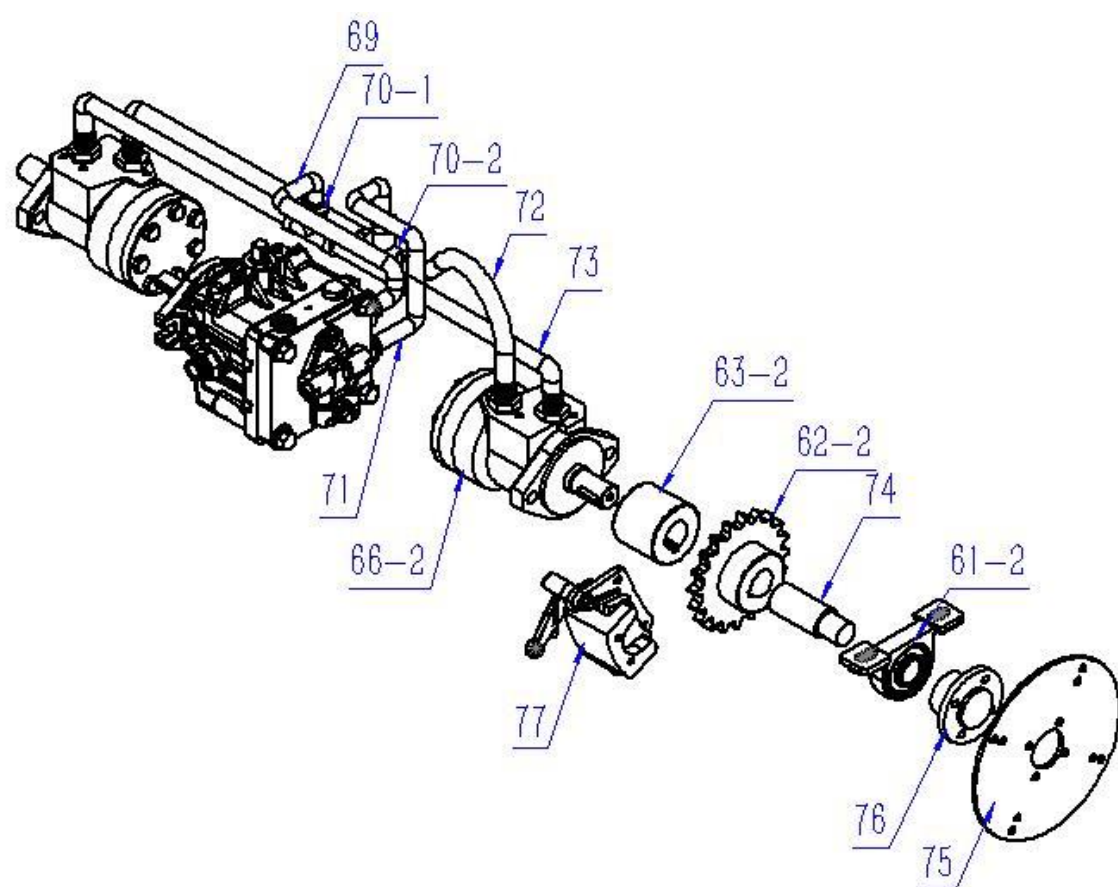
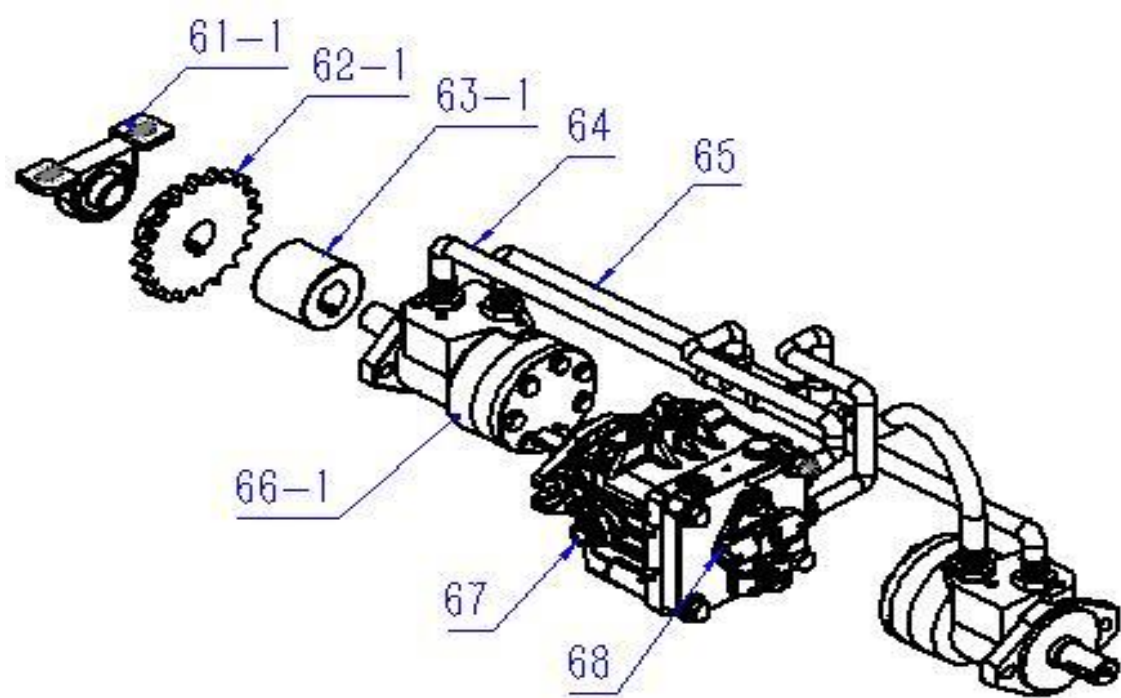

Item	Part No.	Description	Qty.	Serial Numbers/Notes
61	N88-1951	Bearing	1	轴承
62	N75-5152	Chain wheel	1	链轮
63	N52-7766	axle sleeve	2	轴套
64	N87-8560	Hydraulic tubing	1	液压油管
65	N90-4433	Hydraulic tubing	1	液压油管
66	N65-9493	Hydraulic motor	2	液压马达
67	N99-7917	Hydraulic pump	1	液压泵
68	N96-6754	Regulator	1	调节器
69	N96-3649	Hydraulic tubing	1	液压油管
70	N90-2971	Hydraulic tubing	1	液压油管
71	N75-9832	Hydraulic tubing	1	液压油管
72	N86-2355	Hydraulic tubing	1	液压油管
73	N96-8671	Hydraulic tubing	1	液压油管
74	N25-4469	axis	1	轴
75	N10-1129	brake disc	1	刹车盘
76	N86-5805	flange	1	法兰
77	N86-9600	Bearing	1	刹车泵

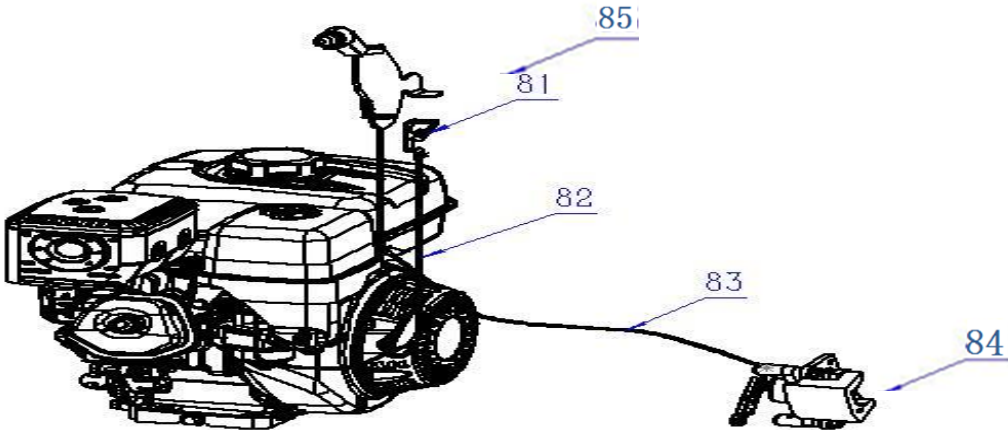

Item	Part No.	Description	Qty.	Serial Numbers/Notes
78	N36-9633	filter element	1	液压滤芯
79	N70-1482	Hydraulic tubing	1	液压油管
80	N78-7139	Hydraulic tubing	2	液压油管
81	N52-2702	Bracket	1	支架
82	N93-9187	Pull the wire	1	拉线
83	N75-7360	Wire harness	1	线束
84	N57-6099	starter	1	启动器
85	N82-6121	Bracket	1	支架
86	N65-3169	engine	1	发动机

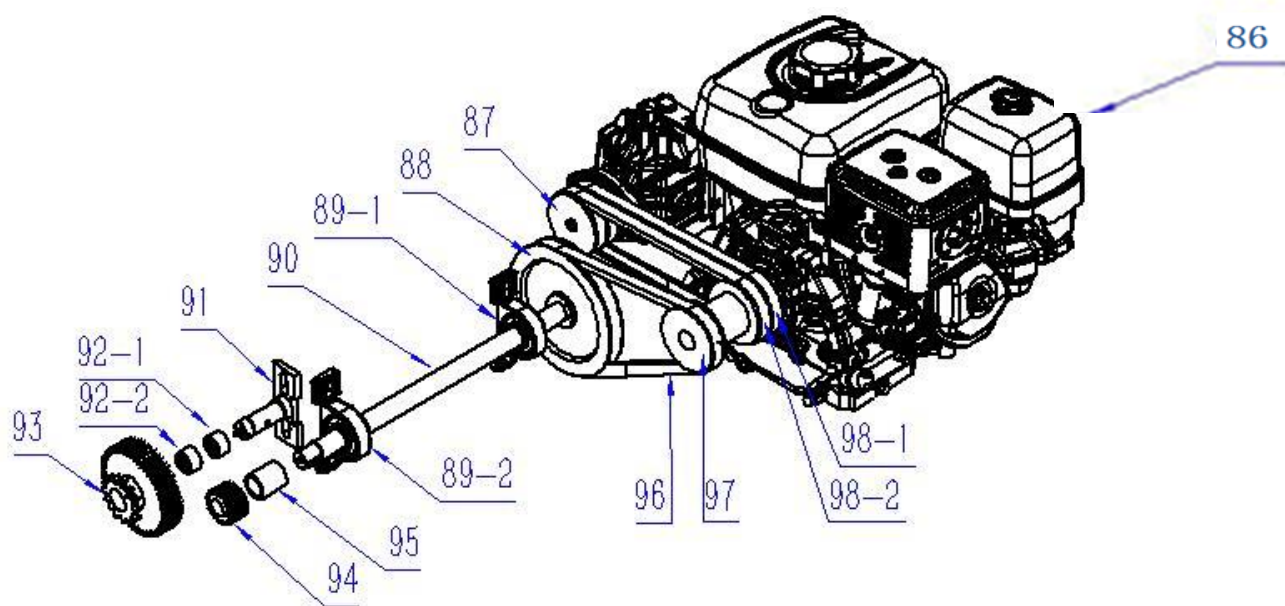

Item	Part No.	Description	Qty.	Serial Numbers/Notes
87	N95-2836	pulley	1	皮带轮
88	N10-7055	pulley	1	皮带轮
89	N68-5246	Bearing	2	轴承
90	N82-2899	axis	1	轴
91	N95-9706	Connector	1	连接器
92	N76-7780	Bearing	2	轴承
93	N52-9023	Chain wheel	1	链轮
94	N80-4884	gear	1	齿轮
95	N76-1507	Bearing	1	轴承
96	N32-7600	Belt	1	皮带
97	N90-9737	pulley	1	皮带轮
98	N80-3807	Belt	2	皮带
99	N10-6585		1	
100	N88-2638		1	

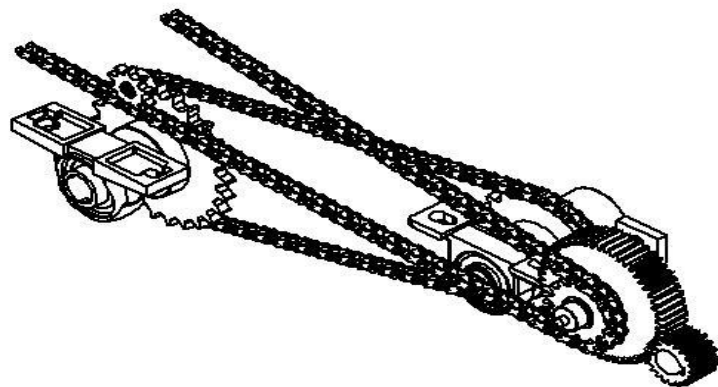
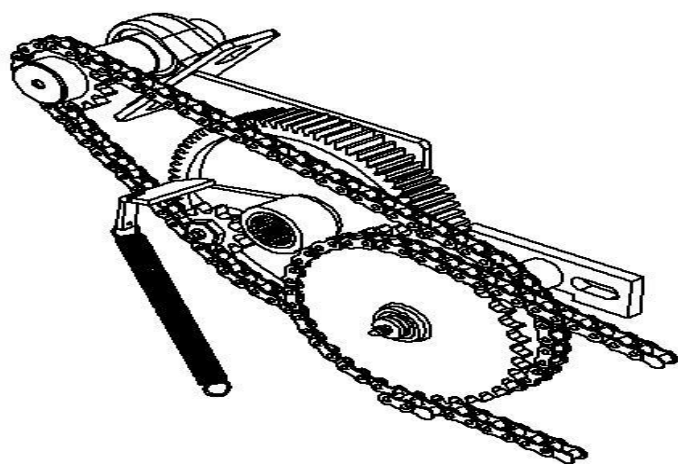
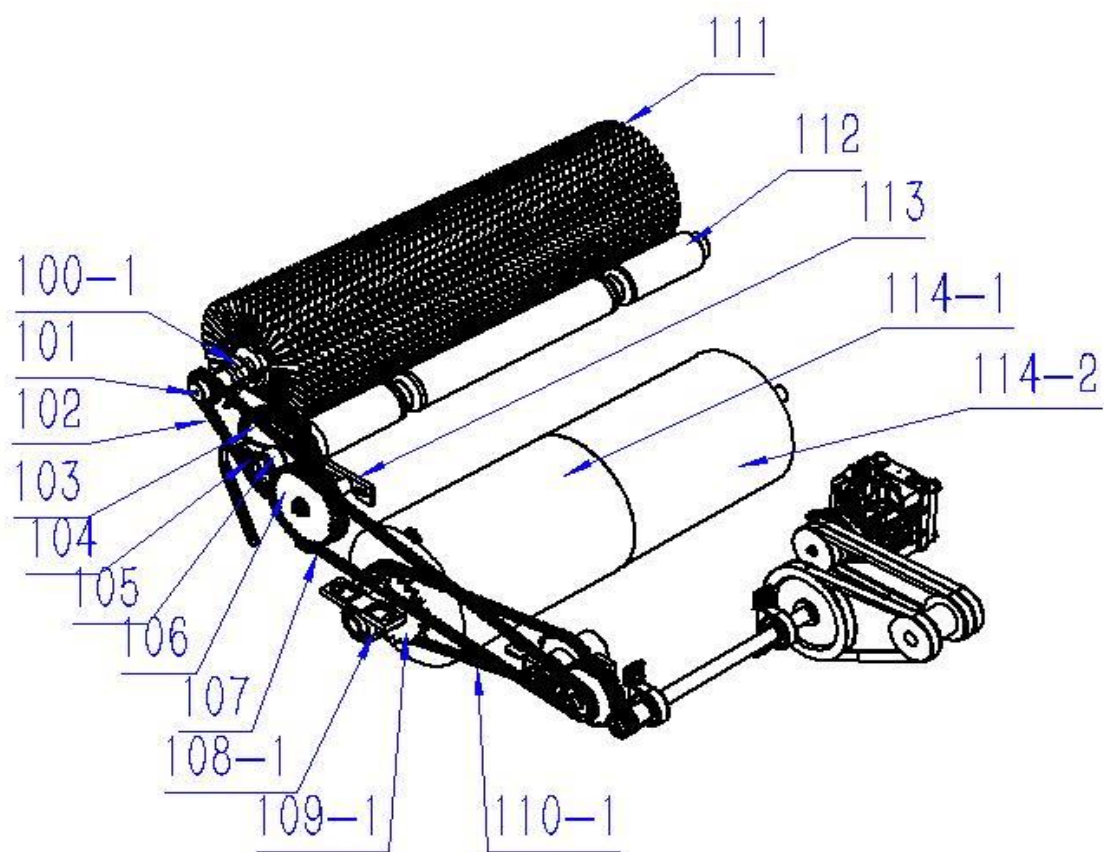

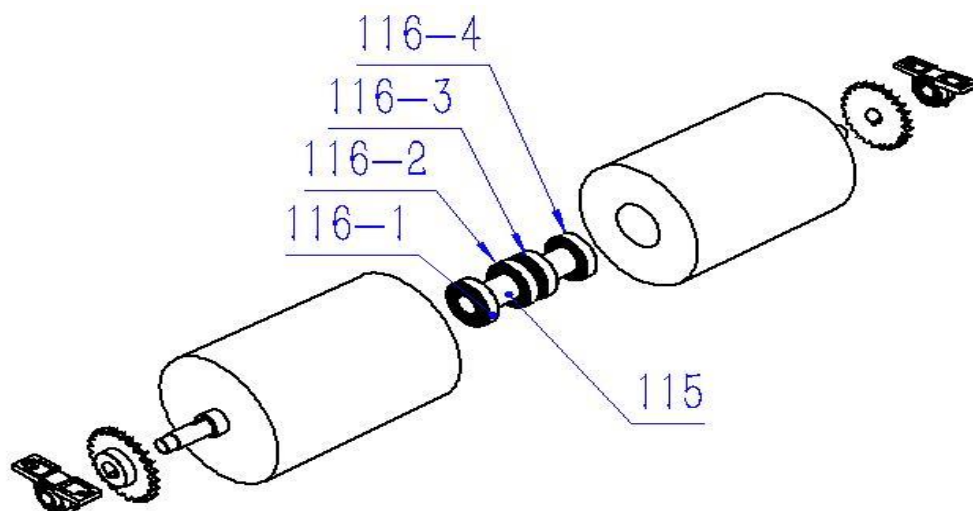

Item	Part No.	Description	Qty.	Serial Numbers/Notes
100	N96-7012	Bearing	1	轴承
101	N96-2524	Chain wheel	1	链轮
102	N32-4615	chain	2	链条
103	N15-7971	Chain wheel	1	链轮
104	N85-6895	axle sleeve	1	轴套
105	N90-9459	Bearing	1	轴承
106	N96-5080	Chain wheel	1	链轮
107	N76-3628	chain	1	链条
108	N97-7952	Bearing	1	轴承
109	N96-6382	Chain wheel	1	链轮
110	N15-9855	chain	1	链条
112	N96-9394	Rolling brush	1	滚刷
113	N15-1029	Bracket	1	支架
114	N90-2237	Rubber roller	2	胶辊
115	N68-7472	axis	1	轴
116	N68-2432	Bearing	4	轴承

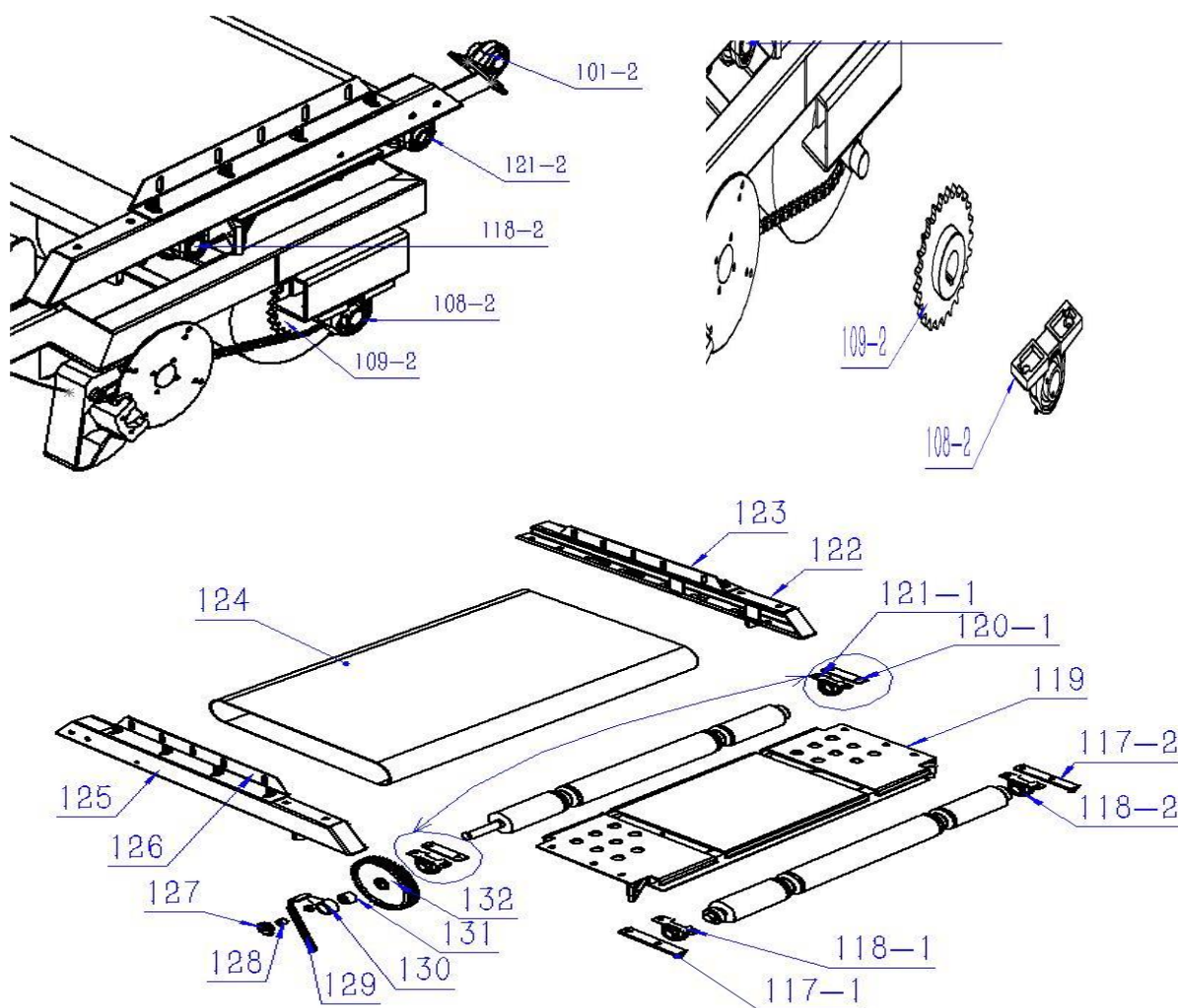

Item	Part No.	Description	Qty.	Serial Numbers/Notes
117	N66-6826	Protective board	1	护板
118	N80-1908	Bearing	2	轴承
119	N36-5265	floor	2	底板
120	N68-5924	Bearing	1	轴承
121	N70-3144	Bearing	1	轴承
122	N76-9109	Side panel	1	侧板
123	N68-2210	Protective board	1	护板
124	N93-9970	Conveyor belt	1	传送带
125	N65-5881	Side panel	1	侧板
126	N85-4315	Protective board	1	护板
127	N95-7441	Nut	1	螺母
128	N70-3855	Butter nipple	1	黄油嘴
129	N96-6856	chain	1	链条
130	N32-8347	Bearing	1	轴承
131	N88-8071	Bearing	1	轴承
132	N93-3646	gear	1	齿轮

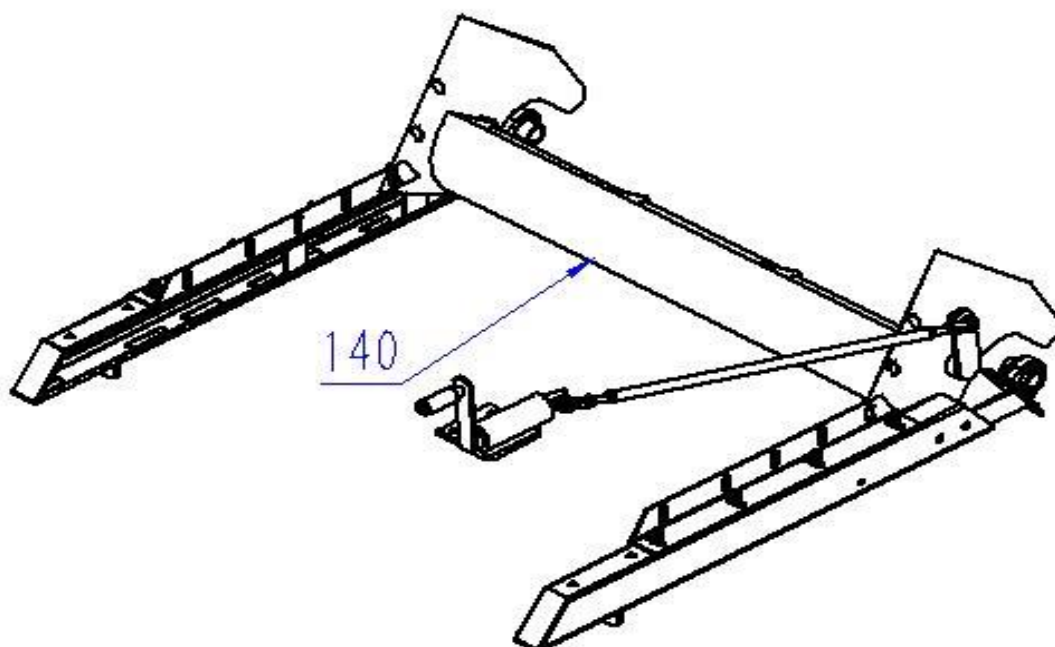
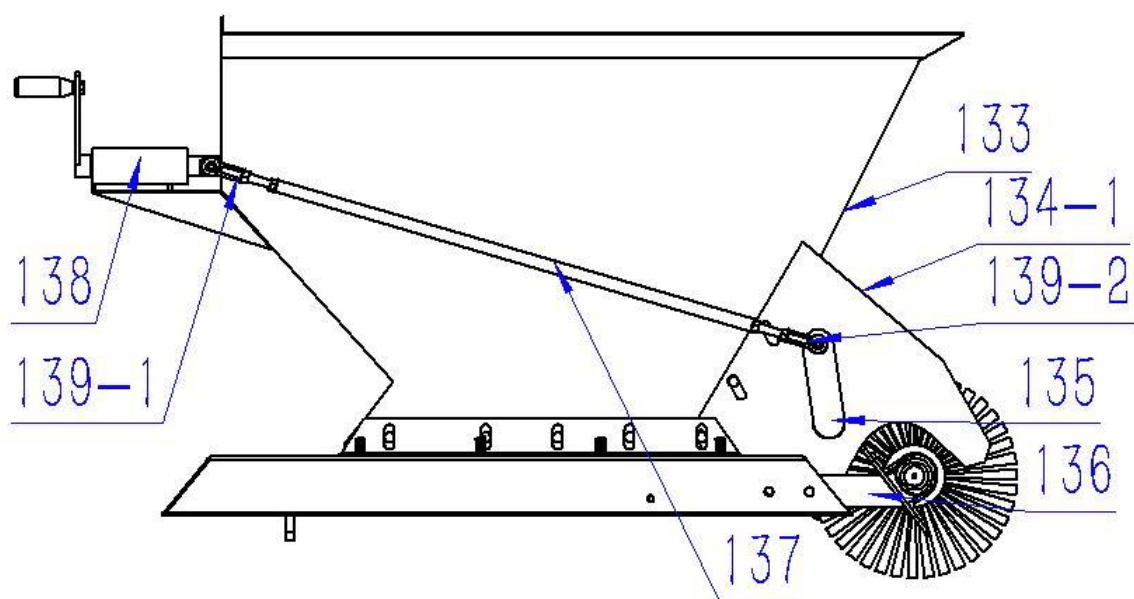

Item	Part No.	Description	Qty.	Serial Numbers/Notes
133	N90-7179	Hopper	1	料斗
134	N76-2857	Side panel	1	侧板
135	N78-5006	Connecting rod	2	连接杆
136	N72-4579	Rolling brush	1	滚刷
137	N86-2283	Connecting rod	1	连接杆
138	N25-7505	Regulator	1	调节器
139	N10-9155	Nut	2	连杆螺母
140	N65-2989	Adjustment board	1	调节板

Equipment maintenance record

Maintenance items	Check the results		Maintenance status	Remark
	normal	Fault		

Shouguang Naco Garden Machinery Co., Ltd.

The pictures are for reference only. Please refer to the actual product. The contents and models published are subject to change without prior notice.



HTTP://WWW.SDNAKI.COM

Shouguang Nake Garden Machinery Co., Ltd

Add: Northside Of The Road, 200 Meters West From Intersection Of
Weigao Road And West Second Ring Road, Shandong, China

E-mail:mhgolfcar@163.com

nakigolf1@gmail.com